

Latimea danturii "h" per modul: 15 mm

Latimea totala "H" per modul: 25 mm

Unghi de angrenare: 20°

Material: otel C45E-UNI EN 10083-1

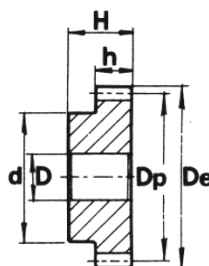
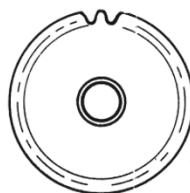

Z (numar de dinti)	Cod	De (mm)	Dp (mm)	d (mm)	D (mm)
12	PM 26012	14	12	9	5
13	PM 26013	15	13	10	5
14	PM 26014	16	14	10	5
15	PM 26015	17	15	12	6
16	PM 26016	18	16	13	6
17	PM 26017	19	17	14	8
18	PM 26018	20	18	15	8
19	PM 26019	21	19	15	8
20	PM 26020	22	20	16	8
21	PM 26021	23	21	16	8
22	PM 26022	24	22	18	8
23	PM 26023	25	23	18	8
24	PM 26024	26	24	20	8
25	PM 26025	27	25	20	8
26	PM 26026	28	26	20	8
27	PM 26027	29	27	20	8
28	PM 26028	30	28	20	8
29	PM 26029	31	29	20	8
30	PM 26030	32	30	20	8
31	PM 26031	33	31	25	10
32	PM 26032	34	32	25	10
33	PM 26033	35	33	25	10
34	PM 26034	36	34	25	10
35	PM 26035	37	35	25	10
36	PM 26036	38	36	25	10
37	PM 26037	39	37	25	10
38	PM 26038	40	38	25	10
39	PM 26039	41	39	25	10
40	PM 26040	42	40	25	10
41	PM 26041	43	41	30	10
42	PM 26042	44	42	30	10
43	PM 26043	45	43	30	10
44	PM 26044	46	44	30	10
45	PM 26045	47	45	30	10
46	PM 26046	48	46	30	10

Z (numar de dinti)	Cod	De (mm)	Dp (mm)	d (mm)	D (mm)
47	PM 26047	49	47	30	10
48	PM 26048	50	48	30	10
49	PM 26049	51	49	30	10
50	PM 26050	52	50	30	12
51	PM 26051	53	51	40	12
52	PM 26052	54	52	40	12
53	PM 26053	55	53	40	12
54	PM 26054	56	54	40	12
55	PM 26055	57	55	40	12
56	PM 26056	58	56	40	12
57	PM 26057	59	57	40	12
58	PM 26058	60	58	40	12
59	PM 26059	61	59	40	12
60	PM 26060	62	60	40	12
61	PM 26061	63	61	50	12
62	PM 26062	64	62	50	12
63	PM 26063	65	63	50	12
64	PM 26064	66	64	50	12
65	PM 26065	67	65	50	12
66	PM 26066	68	66	50	12
67	PM 26067	69	67	50	12
68	PM 26068	70	68	50	12
69	PM 26069	71	69	50	12
70	PM 26070	72	70	50	12
72	PM 26072	74	72	50	12
75	PM 26075	77	75	50	12
76	PM 26076	78	76	50	12
80	PM 26080	82	80	50	12
90	PM 26090	92	90	50	12
100	PM 26100	102	100	60	12

Web : aLLindustrial.ro

Mobil : 0746 55 66 00

Fix : 0374 92 13 13

Fax: 0374 09 78 51

Email : contact@aLLindustrial.ro